

# VEHICLE ENTRANCE MANAGEMENT SYSTEMS

## VV-VM7115HD-BLZ4

HYDRAULIC AUTOMATIC STAINLESS STEEL BOLLARD



### FEATURES

- Automatic hydraulic bollard for high security and strong anti-collision strength
- Swift raising and lowering speed of bollard (optional EFO)
- Emergency release function in case of power failure
- Reliable technology for most intense use at all temperatures and weather conditions
- High grade reflector for long distance visible warning (optional LED light)
- Operation method : control panel button/remote control
- IP68 ingress- protection rating
- AISI 304 grade stainless steel construction

INGRESS  
PROTECTION  
RATING

**IP68**



100%  
Duty Cycle



Hydraulic



Remote  
Controller

## TECHNICAL SPECIFICATIONS

# VV-VM7115HD-BLZ4

Bollard Features	Type	Automatic
	Drive	Hydraulic ram
	Working Speed	Rise to full intercept height in 3-5 seconds
	Safety Reversal Pressure Switch (optional)	Avoid damage by sensing vehicle obstruction and signaling hydraulic drive to retract bollard
	EFO (optional)	Emergency fast operation supports bollard to rise up / lower down in $\leq 1$ second
	Emergency Release	Supports automatic or manual release of the bollard in case of power failure
Physical Features & Characteristics	Visible Warning Signage	High grade reflector tape at the brim (optional LED lights)
	Crash Resistant Design	Tested with vehicle of 1.5 ton weight moving at a speed of 32 Kmph
	Cylinder Diameter	219mm
	Cylinder Intercept Height	600 mm fully elevated
	Cylinder Material	304 stainless steel
	Cylinder Thickness	6mm
	Bollard Underground Housing Dimension	$\phi 270$ mm x 1120mm
	Weight	100Kg
Electrical & Environmental	Weather Protection	IP68 rated
	Operating Voltage	AC 220V, 60Hz
	Working temperature	-40°C to 70°C (heater optional)
	Operating Humidity	$\leq 95\%$ non-condensing humidity
Approvals	Certifications	ISO 9001, ISO 45001, ISO 14001
Hydraulic Drive Control System	Control System	CLC & PLC (Common & Programmable logic control system)
	Control Method	Button control panel, wired & wireless remote control
	Control Groups	1 (optional 2 3 4)
	Maximum Bollard Control	Each control unit can drive up to 8 bollards (optional up to 10 bollards )
	Safety Reversal Pressure Switch	Optional
	Cabinet Material	Mild steel
	Surface Treatment	Degreasing, phosphating, electrostatic spraying
	Weather Protection	IP54 rated
	Operating Voltage	AC 220V, 60Hz
	Dimension	500 x 400 x 200 (mm)

\*Exact products and specifications shown may vary by geographic region and are subject to change without notice. Weights and measurements are approximate and may vary.

# VV-VM7115HD-BLZ4

## DIMENSIONS

Unit: mm

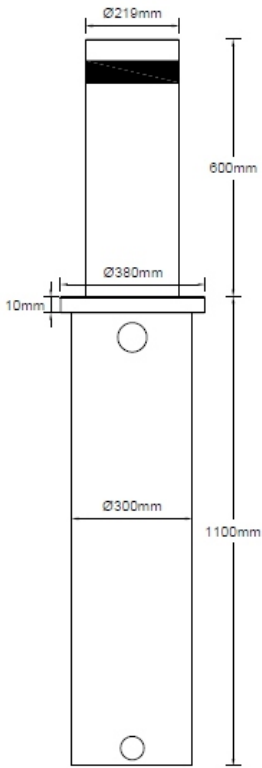

## HPU CONTROL UNIT:

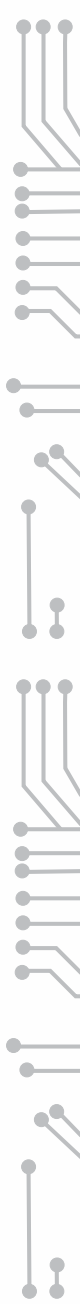
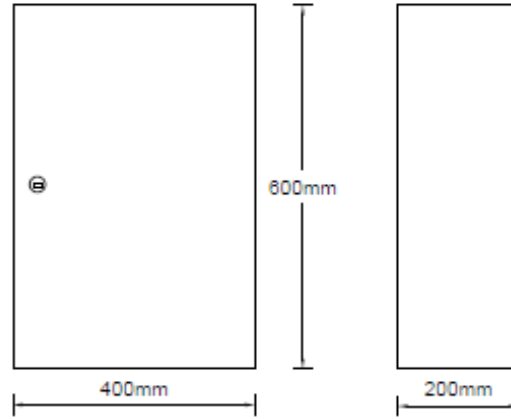

## VANTAGE INTEGRATED SECURITY SOLUTIONS LIMITED.

B3, Bredon House 321, Tenttenhall Road Tettenhall, Wolverhampton

West Midlands, WV6 0JZ United Kingdom

Ph: +44-1902-793383, Email: sales@vantagesecurity.com

[www.vantagesecurity.com](http://www.vantagesecurity.com)

(AN ISO9001 : 2008, ISO14001:2004 CERTIFIED COMPANY)

