

# PEOPLE ENTRANCE MANAGEMENT SYSTEM

## V-PM4240SC/DC-SGT3 SINGLE/DOUBLE MACHINE CORE SWING GATE



### FEATURES

- Heavy-duty motorized-automatic swing gate
- Single/dual machine core with bi-directional operating modes supported
- Half height operation with  $\leq 600\text{mm}$  standard passage width
- LED status indicator & adjustable time out delay
- Automatic reset of swing barrier after each passage
- Integration support with any RFID/Biometric Reader through NO input
- Fail safe function supported in case of emergency
- Top quality AISI 304 grade SS construction with IP54 rating



LED Direction  
Indicators

INGRESS  
PROTECTION  
RATING

**IP54**



100%  
Duty Cycle



Delay Time



Wired  
Terminal

## TECHNICAL SPECIFICATIONS

### V-PM4240SC/DC-SGT3

Parameter	Specifications
Passage width	≤600mm (standard), ≤900mm (optional)
Throughput rate	35-40 persons per minute
Opening & Closing Speed	0.5 ~ 1.5s
Passing Time	5s default (adjustable 0-25s)
Safety Sensors	6 pairs of infrared sensors for smooth passage traffic and protection of pedestrian
Passage Direction	Unidirectional/ bidirectional
Drive	Electro-mechanical DC motor drive
Power/Mechanism Failure	Fail safe status for free passage mode
Fire Alarm Integration	Supported to provide free passage for evacuation
Motor Type	DC brushless motor 150W
Service Life	≥ 10 million operation cycles
Communication Interface	Relay Input (NO/NC/COMM) Optional RS232/RS485
Operating Voltage	DC 24V
Power Supply Voltage	AC100~240 V
Power Consumption	Max. 120W
IP Rating	IP54
Working Temperature	-25°C~+70°C
Relative Humidity	≤90% no condensation
Chassis Material	Main body:304 grade stainless steel, Side Panel : Acrylic
Door Material	Acrylic flaps
Dimension	1400 x 160 x 980 mm
Net weight	35kg single core , 40kg double core
Certifications	CE, ROHS

\*Exact products and specifications shown may vary by geographic region and are subject to change without notice. Product image & weights, measurements are approximate and may vary.

## DIMENSIONS

Unit: mm

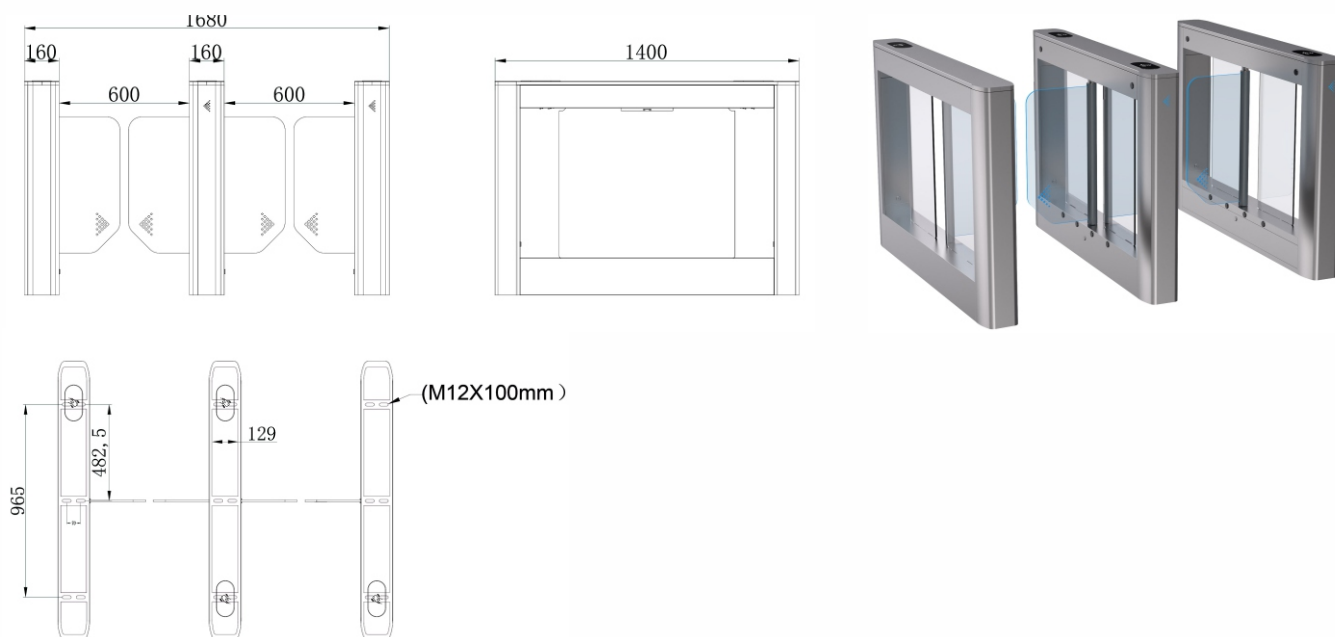

## Installation Diagram:

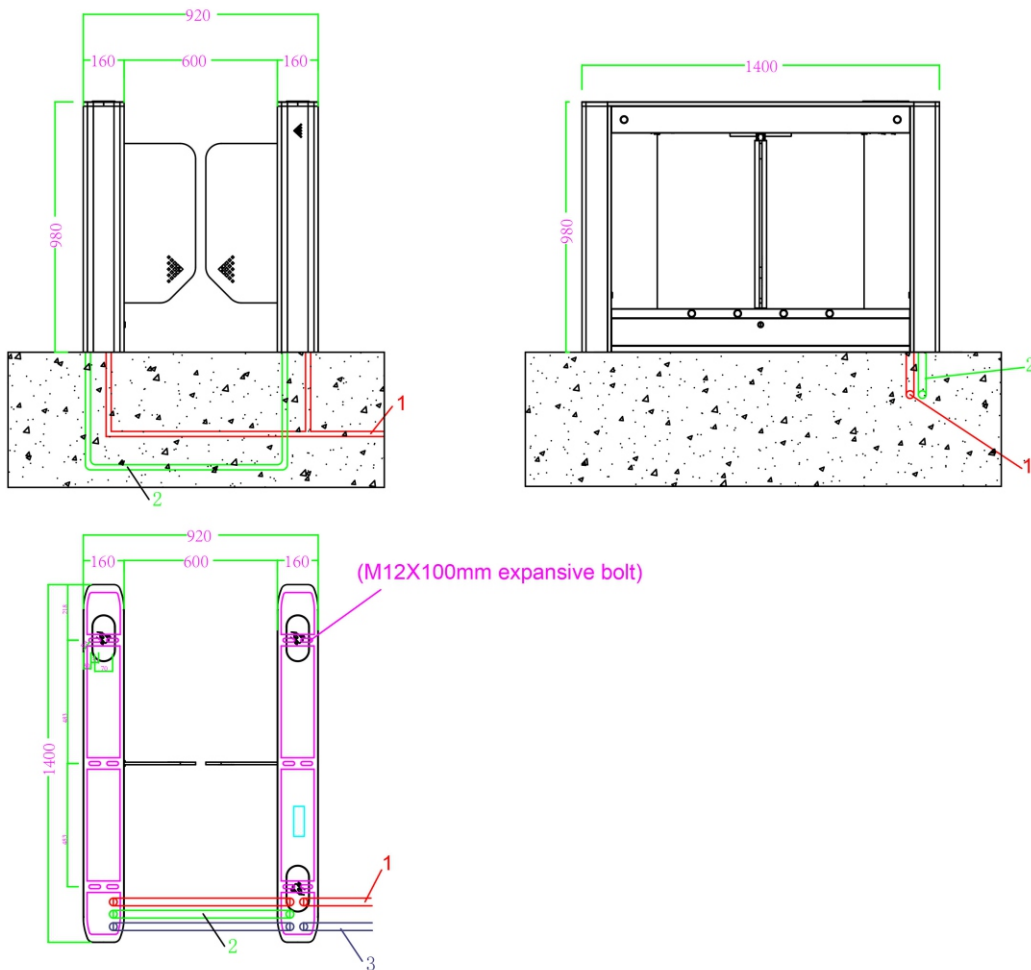

## VANTAGE INTEGRATED SECURITY SOLUTIONS LIMITED.

B3, Bredon House 321, Tenttenhall Road Tettenhall, Wolverhampton

West Midlands, WV6 0JZ United Kingdom

Ph: +44-1902-793383, Email: [sales@vantagesecurity.com](mailto:sales@vantagesecurity.com)

[www.vantagesecurity.com](http://www.vantagesecurity.com)

(AN ISO 9001 : 2008, ISO 14001:2004 CERTIFIED COMPANY)

